



# Cash Drawer



Available Model:  
MRP-13CD  
MRP-16CD  
MRP-18CD

## QuickGuide

English

www.adesso.com

### CONTENT



CASH DRAWER



Coded Key



Quick Start Guide

### DESCRIPTION

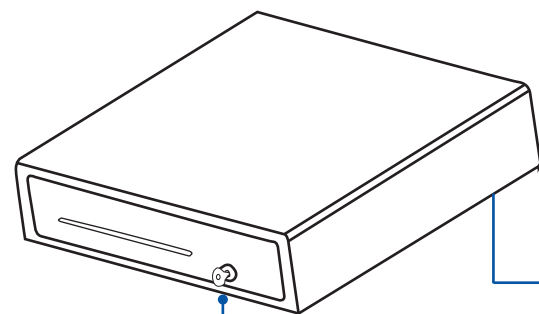

3-Position Locking Latch

Emergency Release Lever (At the bottom)

### LIMITED WARRANTY

ADESSO provides one year limited warranty for the quality of all its products in materials and workmanship.

During this period, ADESSO will repair or replace all merchandise, which proved to be defective. However, ADESSO will not warranty any product which has been subjected to improper freight handling, shipping abuse, neglect or unauthorized repair or installation. The warranty also will not cover products installed with Non-ADESSO components and product with broken sealed and assembly trace. After replacement of RMA, ADESSO reserves the right to request the total cost of the replacement products with broken seals or assembly trace.

If you discover a defect, Adesso will, at its option, repair or replace the product at no charge to you, provided you return it during the warranty period with transportation charges pre-paid to Adesso. You must contact Adesso at support@adesso.com for a Return Merchandise Authorization number (RMA) prior to returning any product. For each product returned for warranty service, please include your name, shipping address (no P.O. Box), telephone number, copy of the bill of sale as proof of purchase and have the package clearly marked with your RMA number.

### SUPPORT

We have listed most of our FAQ's (Frequently Asked Questions) at: <http://www.adesso.com/faqs.asp>. Please visit our FAQ Service & Support pages before you contact our E-mail or Telephone Support.

**Email Support:** If our FAQ's do not help you resolve your issues, please email [support@adesso.com](mailto:support@adesso.com).

**Telephone Support:**  
Toll Free: (800) 795-6788  
9:00AM to 5:00PM PST Monday - Friday

### LOCK FUNCTIONS

Each cash drawer comes with two coded keys. To reduce the possibility of damaging the key, please avoid leaving the key in the lock latch during routine operation.

1. Electrically On-Line:  
The drawer is ready to work with POS terminal. The key may be removed in the 12 o'clock position.

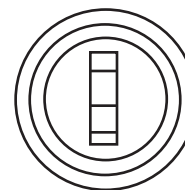

2. Unlocked the drawer:  
Turn the key anti-clockwise from Electrically On-Line position to open the drawer manually.



3. Locked the drawer:  
Turn the key clockwise from Electrically On-Line position to lock the drawer, and then remove the key.



### INTRODUCTION

Adesso Cash Drawer features a classic steel construction with removable insert and coin case. Small in size, yet its sturdy structure with a heavy-duty ball bearing rollers is able to hold a maximum weight load of up to 50 kg.

This basic cash box secured with 3-position locking latch alone with the flexible insert case not only provides effortless security, but also ensures high performance and efficiency. Adesso Cash Drawer is the best choice for quality, dependability, and durability.

### FEATURES

- Drawer Case: 6 Bill Case & 6 Coin Case
- Drawer Interface: Standard RJ12 Connection
- Key Position: 3 Positions (Locked, Unlocked, Electronically On-Line)
- Operating Voltage: 24 V DC ± 10% Pulse Excitation
- Maximum Drawer Load: 50 kg
- Drawer Dimensions: 16" x 16" x 3.9" (410 x 415 x 100 mm)
- Drawer Weight: 14.6 lbs. (6.5 kg)

### REQUIREMENTS

- Connectivity Interface: Standard RJ12 (6 Pin 6C)

### EMERGENCY RELEASE LEVER

The cash drawer can be opened through the following:

1. Setting an electrical pulse from the POS terminal.
2. Using the key to manually open the drawer.
3. Triggering the emergency release lever located at the back of cash box.

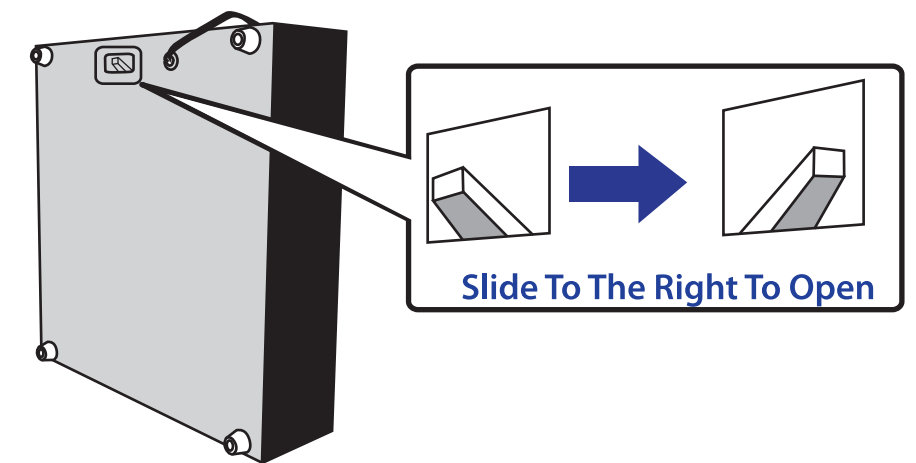

Slide To The Right To Open