



Waterproof Handheld CCD Barcode Scanner



Model: NuScan 2400U

QuickGuide English

www.adesso.com

①

LIMITED WARRANTY

ADESSO provides one year limited warranty for the quality of all its products in materials and workmanship.

During this period, ADESSO will repair or replace all merchandise, which proved to be defective. However, ADESSO will not warranty any product which has been subjected to improper freight Handling, shipping abuse, neglect or unauthorized repair or installation. The warranty also will not cover products installed with Non-ADESSO components and product with broken sealed and assembly trace. After replacement of RMA, ADESSO reserves the right to request the total cost of the replacement products with broken seals or assembly trace.

If you discover a defect, Adesso will, at its option, repair or replace the product at no charge to you, provided you return it during the warranty period with transportation charges pre-paid to Adesso. You must contact Adesso at support@adesso.com for a Return Merchandise Authorization number (RMA) prior to returning any product. For each product returned for warranty service, please include your name, shipping address (no P.O. Box), telephone number, copy of the bill of sale as proof of purchase and have the package clearly marked with your RMA number.

SUPPORT

We have listed most of our FAQ's (Frequently Asked Questions) at: <http://www.adesso.com/faqs.asp>. Please visit our FAQ Service & Support pages before you contact our E-mail or Telephone Support.

Email Support: If our FAQ's do not help you resolve your issues, please email support@adesso.com

Telephone Support:
Toll Free: (800) 795-6788
9:00AM to 5:00PM PST Monday - Friday

②

INTRODUCTION

The sturdy, reliable & long range Adesso NuScan 2400 Waterproof Handheld CCD Barcode Scanner delivers superior extended range performance and versatility for industrial environments. Whether in the garden nursery, a warehouse environment, a manufacturing factory or a retail store, the Adesso Waterproof Barcode Scanner offers durability, accuracy excellent reliability and a user-friendly easy to hold comfortable handle which adds for a more productive mobile environment. The Adesso Nuscan 2400U withstands accidental drops from up to 20ft off the ground and is standard IP67 certified which is waterproof and dustproof. Scan from up to a foot away from your barcode, in the rain, in a dusty warehouse, drop it accidentally or even submerge it in water for 30 min, and you still would not be able to break this scanner's productivity, reliability or durability.

SPECIFICATIONS

- Light Source: 630 nm Visible Red LED
- Depth of Field: Up to 12 inches
- Scan Angle: 42°
- Scan Speed: 200 scans per second
- Minimum Bar Width: 4 mil (Code 39, PCS=90%)
- Print Contrast: Min. 45% @ UPC/EAN 100%
- Indicators (LED): Blue LED & Beeper
- Input Voltage: 5 VDC +/- 0.5V
- Interface: USB

REQUIREMENTS

- Operating system: Windows 7 and above
Mac OSX 10.4 and above
- Connectivity Interface: USB port

③

CONTENTS



NuScan 2400U



Quick Start Guide

DESCRIPTION



④

INSTALLATION

1. Turn on your computer and let your operating system load completely. Plug in the USB cable to the USB port.

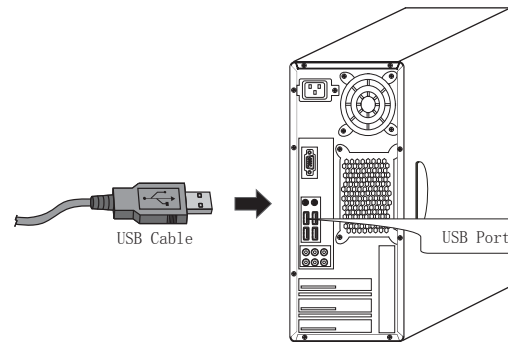

2. Your operating system will detect the device automatically. This device is plug and play, no driver is required.

NOTE:

(POS, or Inventory software is not included, however the scanner works well with all 3rd party software, including MS WORD, Excel and Notepad)

⑤

CAUTION

To avoid damage to the eyes. Do not look directly into the laser beam.

USAGE TIP

Do not hold the scanner directly over a barcode at 90°. Scanning light bounces directly back into the scanner from the barcode label is known as specular reflection which will create a "dead zone" where decoding is difficult. So instead of a 90° head-on approach, tilt the scanner up to 60° forward or backward to achieve a successful decode. Practice a few times to find what range of angles works best.

MAINTENANCE

Cleaning the scan window is the only maintenance required. A dirty window may affect scanning accuracy. Wipe the scanner window gently with a lens tissue or other material suitable for cleaning optical material.

Note:

For basic set up configurations please visit this link from our FAQs: http://www.http://adesso.com/faq/faq_info.php?id=14&typeid=106

If you need to make changes in the configuration of the scanner for specific applications, a full Programming Guide can be downloaded at: <http://www.adesso.com/download/user-manual/NuScan2400.pdf>

⑥