



iMouse™ E1

Vertical Ergonomic Mouse



Model: iMouse E1

QuickGuide

English

www.adesso.com

①

CONTENT



Adesso iMouse™ E1

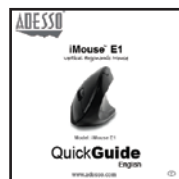

Quick Start Guide

④

LIMITED WARRANTY

ADESSO provides one year limited warranty for the quality of all its products in materials and workmanship.

During this period, ADESSO will repair or replace all merchandise, which proved to be defective. However, ADESSO will not warranty any product which has been subjected to improper freight handling, shipping abuse, neglect or unauthorized repair or installation. The warranty also will not cover products installed with Non-ADESSO components and product with broken sealed and assembly trace. After replacement of RMA, ADESSO reserves the right to request the total cost of the replacement products with broken seals or assembly trace.

If you discover a defect, Adesso will, at its option, repair or replace the product at no charge to you, provided you return it during the warranty period with transportation charges pre-paid to Adesso. You must contact Adesso at support@adesso.com for a Return Merchandise Authorization number (RMA) prior to returning any product. For each product returned for warranty service, please include your name, shipping address (no P.O. Box), telephone number, copy of the bill of sale as proof of purchase and have the package clearly marked with your RMA number.

SUPPORT

We have listed most of our FAQ's (Frequently Asked Questions) at: <http://www.adesso.com/faqs.asp>. Please visit our FAQ Service & Support pages before you contact our E-mail or Telephone Support.

Email Support: If our FAQ's do not help you resolve your issues, please email support@adesso.com.

Telephone Support:
Toll Free: (800) 795-6788
9:00AM to 5:00PM PST Monday - Friday

②

DESCRIPTION

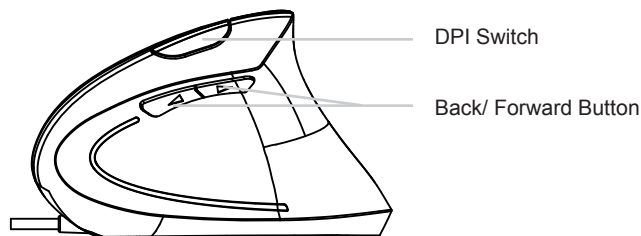
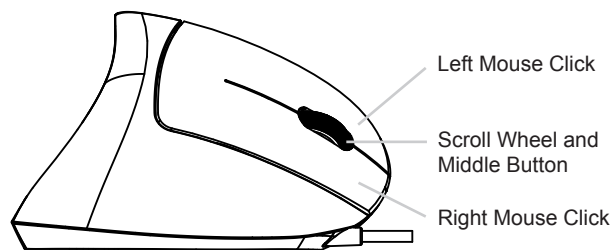

⑤

INTRODUCTION

With the specially designed vertical shape, the Adesso iMouse E1 provides a uniquely comfortable ergonomic mouse experience. Three buttons are conveniently located on the side allowing for intuitive control and faster back and forward browsing.

The switchable DPI (1000/1600) provides for two levels of control. The iMouse E1 is plug and play and requires no drivers. Simply plug into any available USB port and be ready to experience a different kind of mouse!

FEATURES

- Vertical Ergonomic Design with Optical Sensor
- Adjustable Resolution between 1000/1600 DPI
- Six buttons (Left/ Right Mouse Click, Back/ Forward Button, DPI Switch, Scroll Wheel & Middle Button)
- Dimensions: 3.0" x 4.7" x 2.5" (75 x 120 x 63 mm)
- Weight: 0.3lb. (113g)
- Cable Length: 6 ft. (1.8 m)

REQUIREMENTS

- Operating system: Windows® 8 / 7 / Vista / XP / 2000
- Available USB port

③

INSTALLATION

1. Make sure that your computer is turned OFF before installing Adesso iMouse™ E1. This equipment requires a USB port.

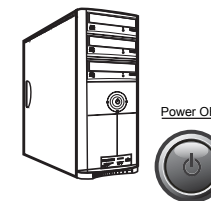

2. Plug in the USB cable of Adesso iMouse™ E1 to the USB port.

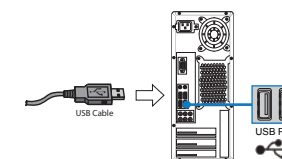

3. Turn ON your computer. Your operating system will detect the device, then the device will work automatically.

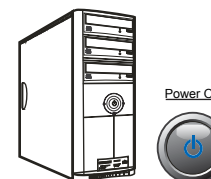

⑥