



# EasyTouch™ 630R

## Smart Card & Magnetic Stripe Reader Keyboard



Model: AKB-630R

# QuickGuide

English

www.adesso.com

①

### SMARTCARD READER SPECIFICATIONS

- EMV 4.0 Level 1 and PBOC2.0 Level 1 certified
- Supports USB 2.0 full speed, USB-IF certified
- Based on ISO7816 implementation
- Supports PC Smart Card industry standard - PC/SC 2.0
- Supports Microsoft Smart Card for Windows
- Meets Microsoft WHQL USB Smart Card Reader requirements
- Meets US Federal Information Processing Standards (FIPS) Publication 201 requirements on smart card reader interoperability
- Smart Card Reader supports T0, T1 Protocol
- Supports ISO7816 Class A, B, and C (5V/3V/1.8V) card

### MAGNETIC STRIPE READER SPECIFICATIONS

- MSR Power Specifications: Wedge - 20mA max
- Operating Temperature: -30 C to 70 C (-22 F to 158 F)
- Mechanical Specifications: Length 3.94" x Width 1.28" x Height 1.23"
- Weight: 4.5 oz.

### CONTENTS



A



B

### LIMITED WARRANTY

Adesso provides a one year limited warranty for all of its products against defects in material and workmanship.

During this period, Adesso will repair or replace any product which proves to be defective. However, Adesso will not warranty any product which has been subject to improper freight handling, shipping abuse, neglect, improper installation or unauthorized repair. The warranty will not cover products installed with components not approved by Adesso and products where the sealed assembly trace has been broken.

If you discover a defect, Adesso will, at its option, repair or replace the product at no charge to you provided you return it during the warranty period with freight charges pre-paid to Adesso. Before returning any product, you must obtain a Return Merchandise Authorization number (RMA). This RMA # must be clearly marked on the outside of the package you are returning for warranty service. Be certain to also include your name, shipping address (no PO Boxes), telephone number, and a copy of the invoice showing proof of purchase in the package.

### SUPPORT

We have listed most of our FAQ's (Frequently Asked Questions) at: <http://www.adesso.com/faqs.asp>. Please visit our FAQ Service & Support pages before you contact our E-mail or Telephone Support.

**Email Support:** If our FAQ's do not help you resolve your issues, please email [support@adesso.com](mailto:support@adesso.com)

**Telephone Support:**  
Toll Free: (800) 795-6788  
9:00AM to 5:00PM PST Monday - Friday

②

### KEYBOARD DESCRIPTION & FEATURES

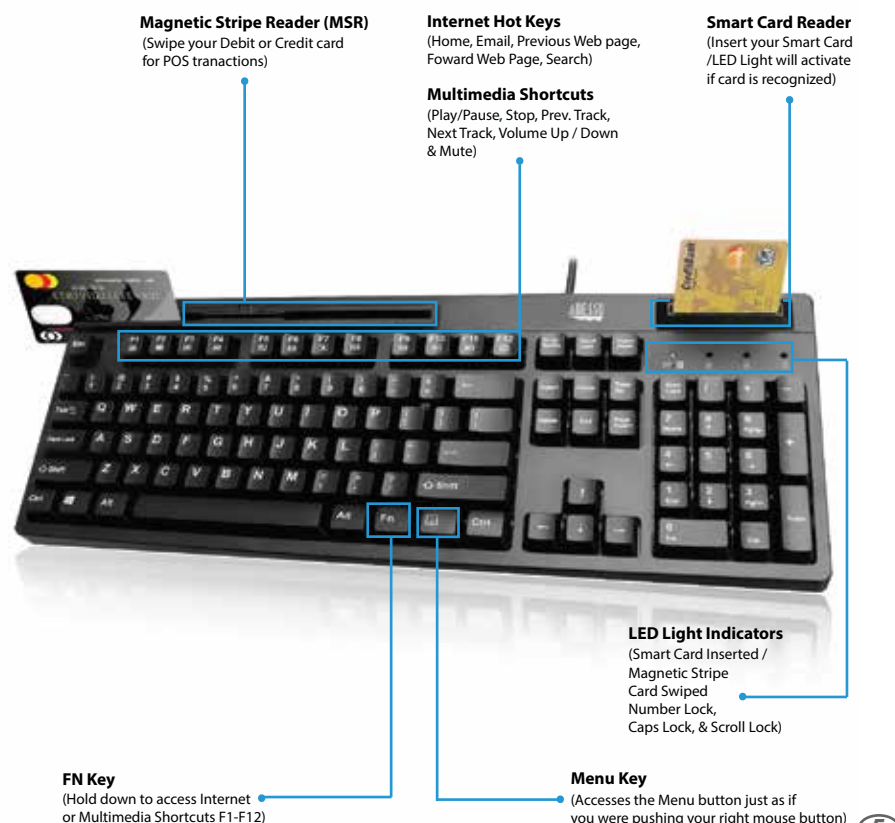

⑤

### INTRODUCTION

Adesso EasyTouch™ 630R Smartcard & Magnetic Stripe Reader Keyboard features a 104-key keyboard layout with a built-in Smart Card Reader (SCR) for banking transactions, identificationsystems, secure web applications, and secure login, as well as a Magnetic Stripe Reader (MSR) for secure Credit Cards.This is the perfect Point of Sale Keyboard with security and multi-functional abilities. This full-sized keyboard is perfect for any desktop, kiosk, office, or warehouse, while the built-in multi-functional hotkeys allow quick access to your multimedia controls and Internet browser commands.The Membrane Key Switches provide instant sound feedback , as well as amazing tactile response, improving accuracy, productivity and efficiency. With all these amazing features, Adesso EasyTouch™ 630 Smartcard & Magnetic Stripe Reader Keyboard is the ultimate all-purpose full-sized keyboard for business, security, and retail.

### KEYBOARD SPECIFICATIONS

- Connectivity: USB Cable
- Keyboard Layout: 104-Key US
- Key Type: Membrane Switch Technology
- Ports: 1 Smart Card Reader Slot; 1 Magnetic Stripe Reader Slot
- Hotkeys: 12 Hotkeys (Internet and Multimedia)
- Indicators: Num Lock, Caps Lock & Scroll Lock
- Dimensions: 18.3" x 6.5" x 1.3" (465 x 165 x 33 mm)
- Weight: 2.5lbs (1100 g)

### REQUIREMENTS

- Operating System: Windows® 10/ 8/ 7/ Vista/ XP/ 2000
- Available USB port

③

### INSTALLATION

1. Make sure that your computer is turned OFF before installing this keyboard

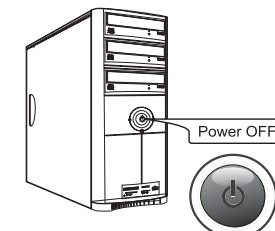

2. Plug in the USB cable into your computer.

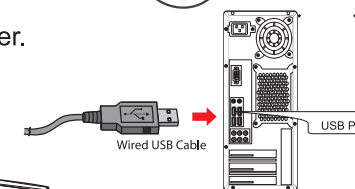

3. Turn On your computer; operating system will detect the device automatically no driver required.

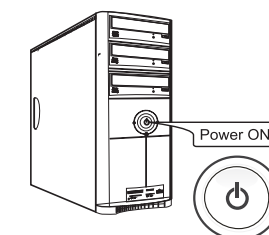

### NOTE:

The Magnetic Stripe & Smart Card Reader LED functions as follows

- LED Light OFF- No Smart Card Inserted or MSR Card Swiped
- LED Light Flashing **GREEN** - Smart Card information / MSR card is being read
- LED **GREEN** - Smart Card is inserted and has been successfully recognized

⑥